

Telpower® Fuses, 70-800 Amps, 170 Volts DC



TPL

DC Power Distribution Fuses

Ampere Ratings: 70-800 Amps.

Voltage Rating: 170 Volts DC

Current Limiting

Interrupting Rating: 100,000A

Construction: Silver-Plated Terminals

Agency Information:

UL Recognized Guide JFHR2, File E56412

Bellcore

CE logo denotes compliance with European Union Low Voltage Directive (50-1000V AC, 75-1500V DC). Refer to BIF document #8002.

Ordering Information: TPL Telpower® (170 Volts DC)

Catalogue Number	Ampere Rating	Carton Qty.	Weight*	
			Lbs.	Kg.
TPL-BA	70	5	.93	.42
TPL-BB	80	5	.93	.42
TPL-BC	90	5	.93	.42
TPL-BD	100	5	.93	.42
TPL-BE	125	5	.93	.42
TPL-BF	150	5	.93	.42
TPL-BG	175	5	.93	.42
TPL-BH	200	5	.93	.42
TPL-BK	225	5	.93	.42
TPL-BL	250	5	.93	.42
TPL-CN	300	1	.49	.22
TPL-CO	350	1	.49	.22
TPL-CR	400	1	.49	.22
TPL-CU	450	1	.49	.22
TPL-CV	500	1	.49	.22
TPL-CZ	600	1	.49	.22
TPL-CZH	800	1	.49	.22

*Weight per carton.

Dimensional Data

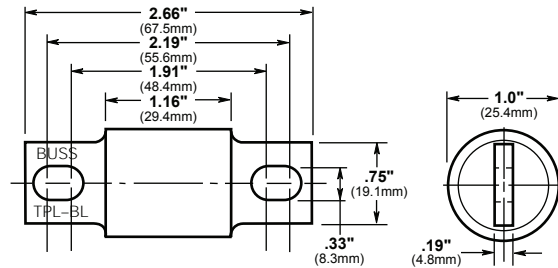

TPL-BA, TPL-BD, TPL-BF, TPL-BH, TPL-BK, AND TPL-BL

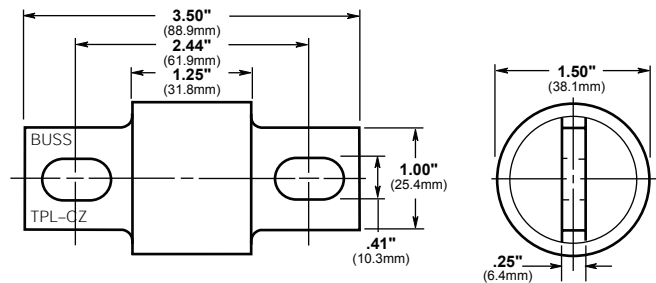

TPL-CN, TPL-CR, TPL-CV, AND TPL-CZ

- Designed for DC power distribution systems.
- Recognized branch circuit protection.
- Current-limiting capability.
- Complete system coordination capability.
- Energy savings with low watts loss, low operating temperatures, and minimum I²t levels.
- Use with Telpower **15100, 15200, TP158HC and TPHCS** disconnect systems.
- For replacement of Bussmann's UBO fuses a TPL-TA adaptor kit is necessary.
- Spare fuseholders:
TPSFH-LB (for TPL-B fuses)
TPSFH-LC (for TPL-C fuses)

Telpower® DC Power Distribution Fuses

TPH

170 Volts, DC, 70-800 Amps

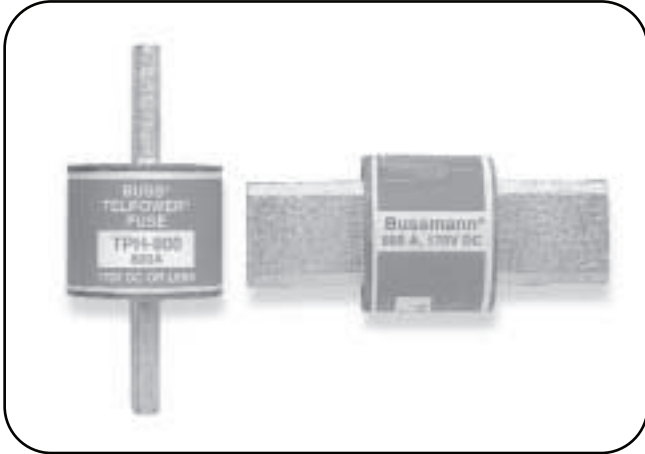

Dimensional Data

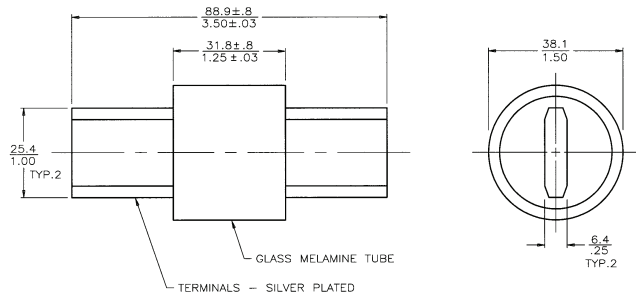

Catalogue Symbol: TPH

DC Power Distribution Fuses

Current-Limiting

Ampere Rating: 70 to 800 Amperes

Voltage Rating: 170 Vdc

Interrupting Rating: 100,000A

Agency Information: cE

UL Recognized, Guide JFHR2, File E56412

Catalogue Numbers, Carton Quantity and Weight

Catalogue Number	Ampere Rating	Carton Qty.	Weight*	
			Lbs.	Kg.
TPH-70	70	1	.55	.25
TPH-80	80	1	.55	.25
TPH-90	90	1	.55	.25
TPH-100	100	1	.55	.25
TPH-125	125	1	.55	.25
TPH-150	150	1	.55	.25
TPH-175	175	1	.55	.25
TPH-200	200	1	.55	.25
TPH-225	225	1	.55	.25
TPH-250	250	1	.55	.25
TPH-300	300	1	.55	.25
TPH-350	350	1	.55	.25
TPH-400	400	1	.55	.25
TPH-450	450	1	.55	.25
TPH-500	500	1	.55	.25
TPH-600	600	1	.55	.25
TPH-800	800	1	.55	.25

*Weight per carton.

General Information:

- Designed specifically for use with the TELPOWER® TPHCS Disconnect Switch series.
- Low watts loss design provides lower operating temperatures.
- Same size as TELPOWER® TPL-C style fuses.
- Spare fuseholder: TPSFH-LC
- TELPOWER® BLUE™ label fuses are specifically designed for dc power distribution systems.
- Minimum I²t short-circuit let-through levels.
- Current-limiting capability.
- Complete system coordination capability.

cE CE logo denotes compliance with European Union Low Voltage Directive (50-1000V AC, 75-1500V DC). Refer to BIF document #8002.

The only controlled copy of this Data Sheet is the electronic read-only version located on the Bussmann Network Drive. All other copies of this document are by definition uncontrolled. This bulletin is intended to clearly present comprehensive product data and provide technical information that will help the end user with design applications. Bussmann reserves the right, without notice, to change design or construction of any products and to discontinue or limit distribution of any products. Bussmann also reserves the right to change or update, without notice, any technical information contained in this bulletin. Once a product has been selected, it should be tested by the user in all possible applications.